

Operation Manual



Healthy Air Automotive Cleansing Unit

E N 3-10

中文..... 11-18

Read First

Thank you for buying the Healthy Air Car Cleansing Unit. Please read this instruction manual before use.

Warranty

This warranty covers the product for a period of 1 year after the date of purchase. Should the user have any problems during this period, please contact the retailer or manufacturer. The warranty is only valid for units that have been used according to these instructions, and for the intended use of cleansing air inside vehicles. The units should not be left running when not under the supervision.

For more information and guidance, or for questions about the product, please contact your retailer.

Warning

The unit will start immediately after being installed, without the start button being activated. This is to allow the air cleansing to begin before the engine is started. The unit may continue to run even once the engine is switched off and the ignition keys have been removed. If the vehicle is to be left unoccupied the unit should be switched off (see start/stop instructions) before leaving the vehicle. Electrical units should not be left running unsupervised, for safety reasons and to prevent the draining of the vehicle's battery.

1 ⚠ Important Information

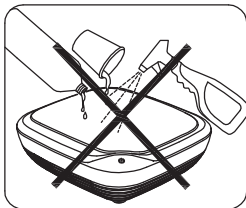

▲ Do not use alcohol, petrol diesel, corrosive cleaners or solvents to clean the unit as this may damage the unit and invalidate the warranty.

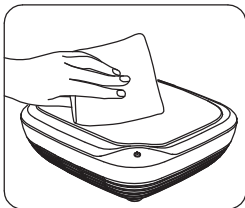

Always disconnect the unit from the power supply prior to cleaning. Wipe with a dry cloth. For more persistent stains, carefully wipe away the stains with a damp soapy cloth, taking care to not get water into the unit.

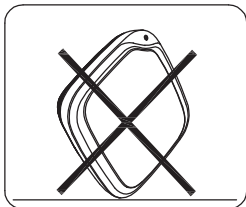

▲ Please operate and use the unit properly as per this manual. This is a complex electrical machine and should therefore be kept away from liquids.

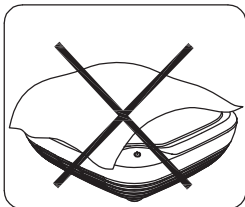

▲ Do not cover the air outlet and air inlet. Use the unit in an open location, so as not to damage the unit.

⚠ Important Information

▲ For your safety, do not operate the unit when driving. Stop your car first.

▲ Keep the unit free of water or moisture, as this could cause the unit to short circuit and cause an electric shock. Keep the unit away from flammable material and possible fire sources.

▲ Please use the enclosed car charging cable, and do not use a foreign power cable. The use of a foreign power cable may damage the product or cause harm to your person.

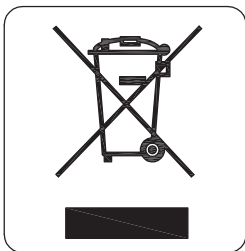

▲ The unit cannot be disposed in normal household waste. However the filter, once used, can be disposed of in normal household waste. The filter is not reusable and cannot be cleaned as it will have absorbed pollutants.

2.1 Components

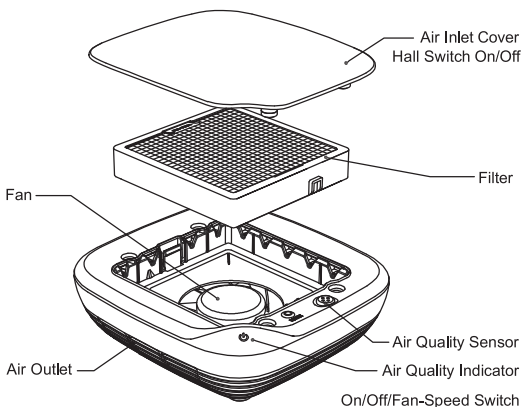

⚠ Important Information

- ▲ The unit needs 30 minutes to warm-up after a long storage, and needs 2 minutes to warm-up when in normal operating condition.
- ▲ If the indicator displays red for a long time, then reset the unit by turning on the unit for 15 to 25 seconds and then powering off.

2.2 Accessories in the package

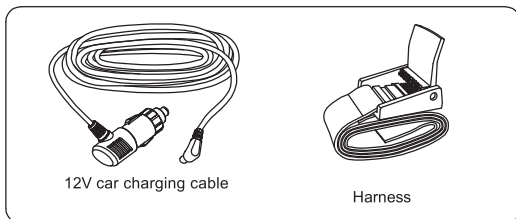

▲ For your safety please install the unit as per these instructions only.

▲ Please only use the power lead and the restraining harness provided, as failure to do so may result in safety issues and/or the product warranty being voided.

3 How to Install the Unit

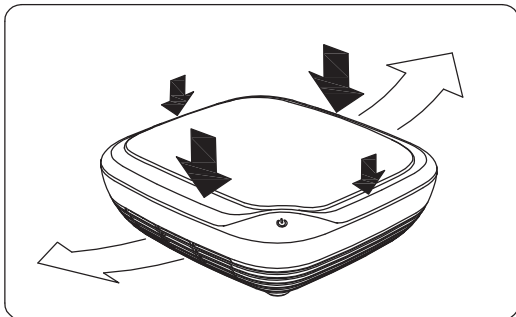

▲ The unit comes with slip resistant rubber feet. However, for safety reasons, the unit should never be positioned on the dashboard, or used while not restrained. Note that many car models have air bags positioned in or near the dashboard and, if deployed, could result in the unit being projectile if left unrestrained.

3.1 Installation-Safety Harness

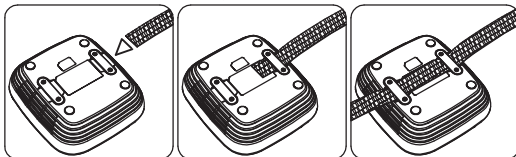

a. Push the harness through the two slots between the bottom case and panels. Use the harness to attach the product around the headrest or armrest.



b. The harness should then be secured in a safe position for both driver and passengers, and allow for safe operation of the vehicle.

⚠ Warning

- ▲ The harness may not fit all car armrests.
- ▲ Do not turn off or operate the unit when driving.
- ▲ Do not use other materials such as tape or rope to install the unit.

4 How to Use the Unit

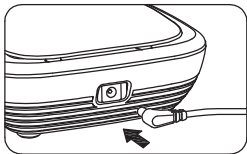

a. Connect the power cable to the unit as shown.

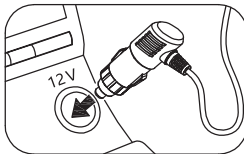

b. Connect the 12V car charging cable to the 12V power socket of your car.

4.1 Pollution Detector system

The unit has a built in air quality detector system to measure both particulates (PM2.5) and common toxic chemical gases such as volatile organic chemicals, nitrogen dioxide and sulfur dioxide prior to the air cleansing activity. The levels of pollution are indicated as follows :-

Blue Lights - lowest level of pollution. Below 2.5 mg/m³

Pink/lilac Lights – dangerous levels of pollution detected. 2.5 to 7.5 mg/m³

Red Lights – very dangerous levels of pollution detected. Greater than 7.5 mg/m³.

The unit automatically adjusts the speed of the fan (and therefore the quantity of air that is treated every minute).

- Blue lights – low fan speed
- Pink/lilac lights – medium fan speed
- Red lights - fast fan speed

▲ This ensures that the unit adjust to the level of polluted air automatically so there is no need to manually adjust fan speed. Once the ambient pollution levels fall to a safe level, the lights will return to a blue colour, and the fan speed will automatically adjust to the lowest fan speed setting.

4.2 Fan settings

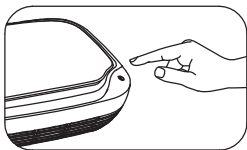

▲ The fan has three speed settings which can be manually adjusted, should it be required. This is done by pressing the start button with a short tap. (Note if the start button is held down for 3 seconds the unit will be turned off.) The unit indicates the fan speed as follows:

▲ One tone indicates it is at its lowest speed setting; Two tones indicate that the fan is in the medium speed setting; Three tones indicate that the unit is at its highest speed settings.

▲ To go into low-speed mode from high speed mode, press the button. You should hear a single tone, indicating that the fan speed has changed from High-Speed to Low-Speed mode.

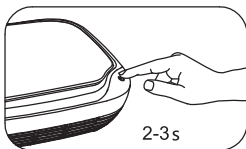

▲ To go into stand-by mode, hold the button for 2-3 seconds. You should hear a single tone, indicating that the fan has entered standby.

▲ Warning – Never change the settings on the unit when operating the vehicle, as it may distract the driver from safely operating the vehicle.

5 Filter system

The unit will arrive with a Pollution Eraser air filter produced by Healthy Air Technology Ltd, which is located under the protective cover. This cover is kept in place by magnetic fixings, and the unit will automatically power off if the cover is removed.

The filtration system used by the unit is made up of several filters, including a pre-filter, HEPA filter and a Healthy Air Pollution Eraser catalyst filter. This composited filter is very compact, while still removing PM2.5 particles and absorbing/converting the chemical gas and unpleasant odor to be harmless gas.

The pre-filter catches bigger particulates such as human and pet hair. The HEPA filter can remove the fine particles as small as 0.3 μm in diameter, such as airborne microorganisms, fungi, viruses, dust and pollen. The Healthy Air catalyst filter can absorb and breaks down unpleasant odors, such as smoke, airborne TVOC (formaldehyde, benzene, methylbenzene, etc.) and noxious gasses including H₂S, NO_x and SO_x, while also killing viruses. These different filters provide pure, safe and healthy air for the whole family.

High Air Pollution Cleansing Power

Product Air Cleaning Performance*

Target Pollutant	Clean Air Delivery Rate (CADR)	Cleaning Energy
Particle	25.9m ³ /h	High Efficiency
Formaldehyde	6.0m ³ /h	High Efficiency
Noise (Sound Power Level)	53.8dB(A)	

*Complying with GB/T18801-2015, Tested in 3m³Chamber for 1 hours.

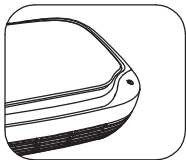

⚠ Important Information

If the air quality indicator is twinkling continuously, you may need to replace the filter.

▲ You must replace the old filter with the Pollution Eraser air filter produced by Healthy Air Technology Ltd.

▲ Otherwise, performance is not be guaranteed and any related issues may not be covered by your warranty.

5.1 How to Replace the Filter

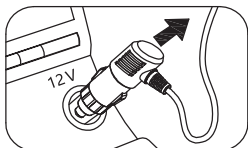

a. Disconnect the power supply.



c. Remove the filter as shown.

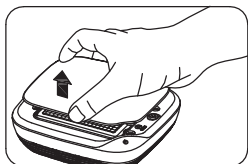

b. Remove the cover as shown.



d. Use the groove and insert the new filter.

▲ The filter may easily be removed and replaced by pulling on the ribbon attached. The filter only can be inserted in one direction, shown as the above photo. Please do not force the filter in. The Filter must be replaced, and the reset operation undertaken (see later).

5.2 Reset the Unit After Replacing the Filter

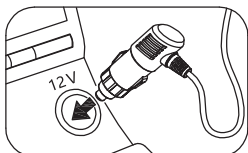

a. If the filter has been disturbed or removed, or the unit has been operating on the high fan setting for a long time, the unit will require resetting. The reset hole can be found by removing the filter cover. The unit should then power up in stand-by mode.

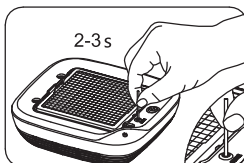

b. Using a pin, press the reset button, holding for 2-3 seconds. After you hear a double tone, and the air quality indicator light has turned on, release the RESET button.

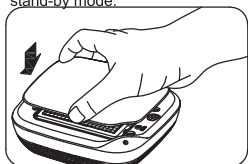

c. Replace the cover. The unit should turn on in low speed mode. You have reset the car air cleaning unit successfully.

Note: Replacement filter can be bought from your retailer or Healthy Air Technology Ltd.

Important Information

- ▲ The product has a built-in sensor, for your safety, the unit will turn
- ▲ off if the cover is removed while the fan is running , and there will
- ▲ be a continuous tone.

6 The troubleshooting

Question 1

I cannot start the unit

Solution1

- ▲ Check if the power cable is connected to the unit, and the 12V power supply is on.
- ▲ Check if the cover is attached properly.
- ▲ Press the power switch again. If it still does not start up, please contact your retailer.

Question 2

In some cars, the unit does not switch off when the car engine is turned off.

Solution 2

To avoid exhausting the car battery, the unit will turn off automatically after continuously running for 2 hours.

Question 3

There is still an unpleasant odor even after using the unit for a short period of time.

Solution 3

This problem occurs especially in new cars, which may smell strongly of factory materials such as leather, plastics and glue. To get rid of such odor keep the unit running continuously. This will greatly reduce the air pollutants. Even so, some of the odor may persist.

Question 4

Why does the fan change speeds automatically?.

Solution 4

The unit uses an air quality sensor to estimate the level of pollutants in the car and adjusts to the suitable fan speed automatically. You can also adjust the fan speed manually.

Question 5

After replacing the filter, the air quality indicator is blinking continuously..

Solution 5

The unit needs to be reset after replacing the filter. See the reset procedure.

▲ Question 6

How long before I need to replace the filter?

▲ Solution 6

When you need to replace the filter, the air quality indicator will blink continuously. How often this is depending on the air quality in the ▲car, frequency of use and personal habits (such as smoking). On average, you should need to replace your filter once every 3-5 months with light use, and every 2 months with heavy use.

Healthy Air Technology Ltd
South Park Road
Oxford, UK
OX1 3QR

首先阅读

感谢您购买车载空气净化器。请妥善保管此说明书，安装、使用Healthy Air车载空气净化器之前，请花一点时间阅读本说明书。

保修和服务

保修适用范围：

- ▲ 产品严格按照指定用途操作；
 - ▲ 产品依照使用说明书使用；
- 车载空气净化器保修不适用于事故、失误或使用不当引起的产品损坏。

欲知详情和指导，或对产品有疑问，
可联系您的零售商。

1 ⚠ 重要事项说明

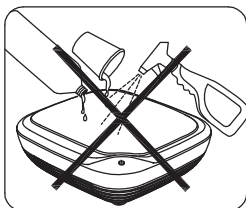

▲ 禁止用酒精、汽油、化学溶剂或腐蚀性材料清洁本产品。

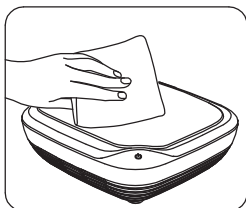

需要清洁车载空气净化器时
▲ 将车载空气净化器的电源断开。
▲ 仅使用柔软抹布擦拭。

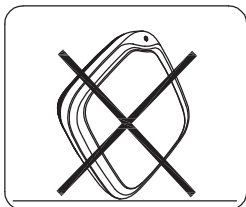

▲ 请妥善放置和使用本产品，防止受撞击和跌落，本产品安装并固定在车内的指定位置。

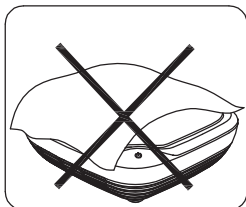

▲ 请勿将外部物体掉入或堵塞本产品出风口及进风口，应务必保持产品风道畅通，以免造成产品损坏。

⚠ 重要事项说明

▲ 为了您的安全，切勿在驾车时调节净化器。请先停车！

▲ 禁止产品沾水或受潮，否则会造成短路和触电危险。请勿靠近或接触可燃性物质或火源等。

▲ 请使用包装盒内配套点烟器电源，禁止使用其它电源线，使用其它规格电源可能会造成机器损坏或发生危害。

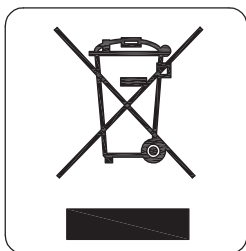

▲ 为环保尽一份力。切勿将净化器同生活垃圾一起丢弃。过滤网则属于生活垃圾一类。

2.1 认识车载空气净化器

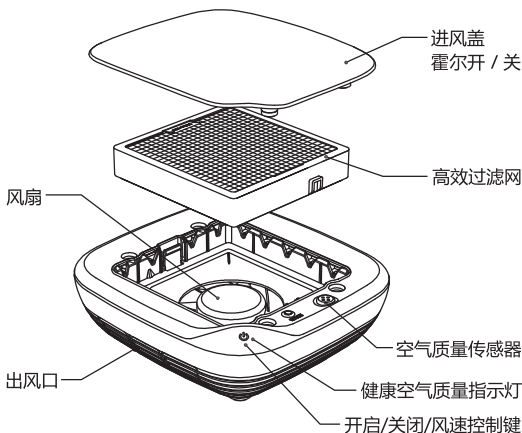

⚠ 注意

▲ 净化器长时间储存后，初次上电使用需预热30分钟以上；净化器正常工作模式预热2分钟可进入工作状态。

▲ 如果净化器出现污染指示（长时间处于重度污染状态下，如LED空气质量指示灯长时间亮红灯），则需要对净化器进行记忆复位调试操作。操作如下：将净化器通电控制15-25秒内，然后断电，此时净化器将自动清除当前零点，恢复出厂设置。

2.2 熟悉车载空气净化器的盒内配件

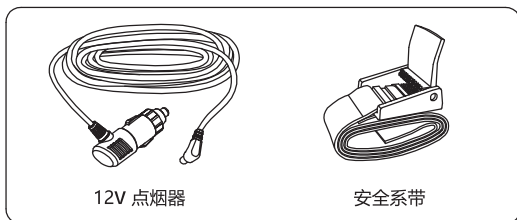

▲ 为了您的安全，请依照使用说明安装净化器。

▲ 为了您的安全，请只使用本包装盒内的配件安装净化器。我们不承担任何因安装不当而引起的损害或事故责任。

3 安装车载空气净化器

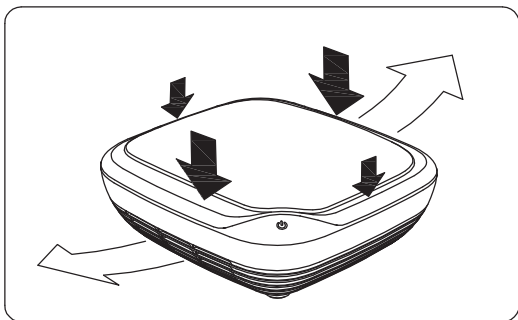

▲为确保正常运转，请务必在通风良好处安装净化器。

3.1 使用头枕或扶手

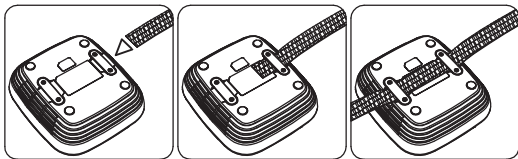

a. 请尝试将安全系带顺利穿过底壳左右两小盖板。

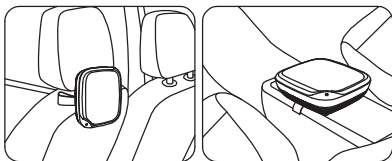

b. 使用安全系带将产品系在头枕或扶手上。

⚠ 注意

- ▲安全系带不一定适合所有车的扶手。
- ▲切勿在行车时试图关闭或操作净化器。
- ▲切勿使用其它设备，如胶带、绳子等等。

4 使用车载空气净化器

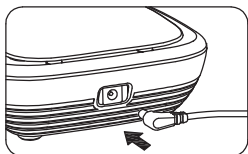

1. 依图示，将净化器连上电源线。

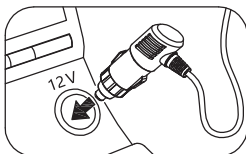

2. 在车内将12伏点烟器插头连上12伏电源插座。

4.1 熟悉车载空气净化器的智能变频

- ▲ 当车载电源启动时，净化器将自动运行在低档模式。
- ▲ 车载空气净化器具有三个档位：低档，中档，高档。
- ▲ 低档模式默认为智能变频。车载空气净化器会根据自带的空气质量传感器，判断当前车内空气质量，然后调整适合的档位。
如：
车内空气质量良好时---指示灯显示蓝色，净化器运行在低档；
车内空气质量一般时---指示灯显示紫色，净化器运行在中档；
车内空气质量较差时---指示灯显示红色，净化器运行在高档。
- ▲ 如果想要加快净化速度，可手动切换至高速净化模式，快速净化车内空气。

4.2 熟悉车载空气净化器的档位切换

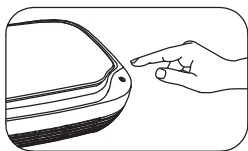

- ▲ 净化器运行在低档时，触摸控制键并伴随“嘀，嘀”两声，从低档进入中档运行。
- ▲ 净化器运行在中档时，触摸控制键并伴随“嘀，嘀，嘀”三声，从中档进入高档运行。
- ▲ 净化器运行在高档时，触摸控制键并伴随“嘀”一声，从高档进入低档（智能变频）运行。

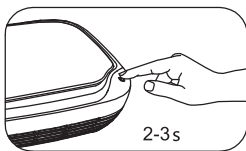

- ▲ 运行状态下，持续触摸控制键2-3秒，伴随“嘀”一声，净化器将进入待机状态。
- ▲ 待机状态下，触摸控制键并伴随“嘀”一声，净化器将开机并低速运行。
- ⚠ 为了您的安全，切勿在驾车时调节净化器。请先停车！

5 车载空气净化器-净化过程

车载空气净化系统采用了由多层过滤网组成的褶皱型复合滤网，复合材料解决了产品结构的空间限制，实现同步去除 PM2.5颗粒物和吸附其他化学气体及异味的效果。

▲ 预过滤网捕捉人的头发和宠物毛发等较大的颗粒。

▲ HEPA过滤网去除小至0.3微米的微细颗粒，如空气中的微生物、细菌、病毒、灰尘和花粉。

▲ HESA过滤网消减异味，如烟味，并净化空气中的TVOC（含甲醛、苯、甲苯等气态化学污染物）和有害气体。

高效净化技术

产品性能指标*

目标污染物	洁净空气量(CADR)	净化能效等级
颗粒物	25.9m ³ /h	高效级
甲醛	6.0m ³ /h	高效级
噪音 (声功率级)	53.8dB(A)	

*按照国标GB/T18801-2015测试，在3立方仓测试1小时

⚠ 重要事项说明

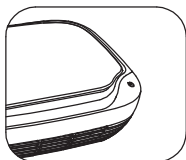

当需要更换过滤网时，健康空气质量指示灯连续闪烁，提示您进行更换。

▲ 务必使用车载空气净化器过滤网正品并及时更换过滤网。

▲ 这将维持您的车载空气净化器的最佳性能并确保车内空气最大纯净度。

5.1 如何更换车载空气净化器过滤网

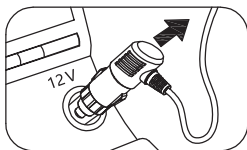

a. 将车载空气净化器设备同电源断开。

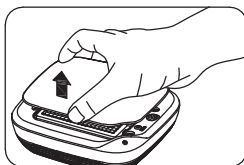

b. 依图示打开车载空气净化器进风盖。

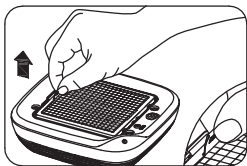

c. 依图示取出过滤网。

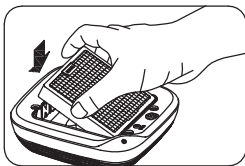

d. 使用沟槽，插入新的过滤网。

⚠ 过滤网只能单向滑入，切勿强行安装。参见上图

5.2 更换过滤网后重置车载空气净化器

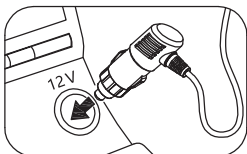

1. 机器在连接电源情况下，保持待机状态。

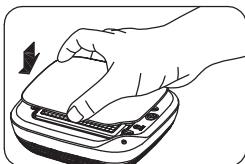

3. 安装进风盖，净化器低速运行。净化器重置成功。

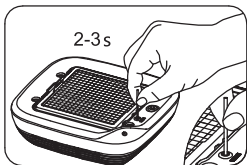

2. 长按RESET键2-3秒，空气质量指示灯亮起并伴随"嘀、嘀"两声，松开RESET键。

⚠ 重要事项说明

- ▲ 开盖保护功能
- ▲ 霍尔磁感应防护
- ▲ 为了安全起见，机器运行中若不慎打开进风盖，净化器将自动关闭，蜂鸣器连续单声响"嘀、嘀、嘀....."。
- ▲ 安装进风盖，净化器进入当前运行状态。

6 车载空气净化器疑难解答

问题 1

无法启动车载空气净化器。

解答1

- ▲ 检查电源线,确保插座已插紧。
- ▲ 确保已正常安装进风盖。
- ▲ 再次触摸控制键,如果仍然不能启动机器,请联系零售商。

问题2

某些车型即使在熄火时,仍然继续输出12V电压。

解答 2

为避免电池耗尽,车载空气净化器将在连续运转两小时后自动关闭电源。

- ▲ 如欲再次启动车载空气净化器,请触摸控制键。

问题 3

车载空气净化器已运转一段时间了,我的车内仍然有异味。

解答 3

车内的某些异味来源于皮革、塑料、胶水散发出来的化学污染以及食物残渣残留的味道。车载空气净化器会对这些污染进行过滤并能持续净化空气,显著减少空气污染物。尽管如此,某些异味可能会断续存在,建议在行驶过程中保持空气净化器的开启。

问题4

自动模式是什么工作原理?

解答4

车载空气净化器会根据自带的空气质量传感器,判断当前车内空气质量,然后调整适合的风档,无需手动操作。如果想要加快净化速度可手动切换至高速净化模式,快速净化车内空气。

问题5

更换过滤网后,车载空气净化器的空气质量指示灯连续闪烁。

解答5

- ▲ 机器在连接电源情况下,保持待机状态。
- ▲ 长按RESET键2-3秒,空气质量指示灯亮起并伴随"嘀、嘀"两声,松开RESET键。
- ▲ 安装进风盖,净化器低速运行。净化器重置成功。

问题6

滤网多长时间需要更换?

解答6

当需要更换过滤网时,健康空气质量指示灯连续闪烁,提示您进行更换。过滤网的更换时间与您车内空气质量以及车载空气净化器的使用频率和时间、个人习惯(如:吸烟)等直接相关。若车内污染不严重,建议3-5个月更换一次过滤网;若您吸烟用户,建议2个月更换一次过滤网。

